

Specifications for Tower 8 & 9

SPECIFICATIONS	
Airconditioned Apartments fitted with Energy Efficient VRV Airconditioning Sysytem excluding Toilets.	
Flooring of Imported Italian Marble in Living Room, Bedrooms and Toilets, Combination of Vitrified/ Ceramic Tiles/Granite/Marble in Staircase and Corridors.	
Windows of Double Glass (DGU) High Quality UPVC to minimize consumption of Airconditioning & eliminate Sound Pollution.	
False Cielings in Foyer, Passage, Living & Dining Room and a Bedroom	
Imported Modular Kitchen Cabinets and Wardrobes in Bedrooms	
Fans & Decorative Lighting in all Bedrooms & Living Rooms.	
Structure	RCC Framed Structure with Brick Walls
External Finish	Combination of Italian Stone Cladding from Ground Floor to Second Floor & rest of the Building with Weather Coat/ Stone Finish Coats.
Wall Finishes	Internal Walls - Plastered and Painted with pleasing shades of Acrylic Luxury Paints.
Toilet Walls	Dado of Glazed/ Ceramic Tiles up to 8 feet Height
Fittings	Wash Basin, EWC, Towel Rail, Hot & Cold Water System.
Kitchen	Prepolished Granite Platform with Stainless Steel Sink, Dado of Glazed/ Ceramic Tiles up to 2 feet Height above Platform.
Electrical	Copper Concealed Wiring, Decorative Lights, Plug points in Each Bedroom, Drawing/ Dining & Lounge.
Doors	Hardwood Framed & Both Side Teak Finish Flush Doors/ Double Glazed uPVC Doors & Frames
Parking	Dedicated Parking Space with each Apartment
Others	Advance Fire Fighting System & Power Back
Facilities	
Facilities Such as Social Club comprising Indoor Games like Snooker, Table Tennis carrom etc. with Card Room, Community Hall, Party Hall, Dining Hall. Health Club with facilities like Gym, Steam Sauna, Jacuzzi, Massage Therapy, Meditation and Yoga Center are being Planned	
Beautiful, Strategically placed Convenient Shopping Center to keep your basic provisions within Reach.	

About Us

SDS Group is a highly prestigious & professionally managed group having its deep roots in Noida, Greater Noida and Yamuna Expressway area which fall in the NCR Region of India. The Group has been perceived as a Reputed, Customer Friendly & Focused Corporate House of this Region which achieved the sturdy & fast growth since its inception. SDS is committed to consistently deliver quality construction, timely completion and ensure customer satisfaction, and has earned a massive name and trust in the industry of real-estate.

The Group is having Group Housing Projects & Integrated Township spread over 125 Acres of Land at Prime Location.

VISION

SDS Group has a vision to achieve the admiring position among the top Real Estate Developers of India by continuous positive efforts in the field of Quality Housing & Customer Satisfaction. The Group has a clear policy to Develop Best & Strategically Located Properties only for the greater satisfaction of End Users & Investors.

MISSION

Aspire to transform Urban living by putting highest standards in all its actions.

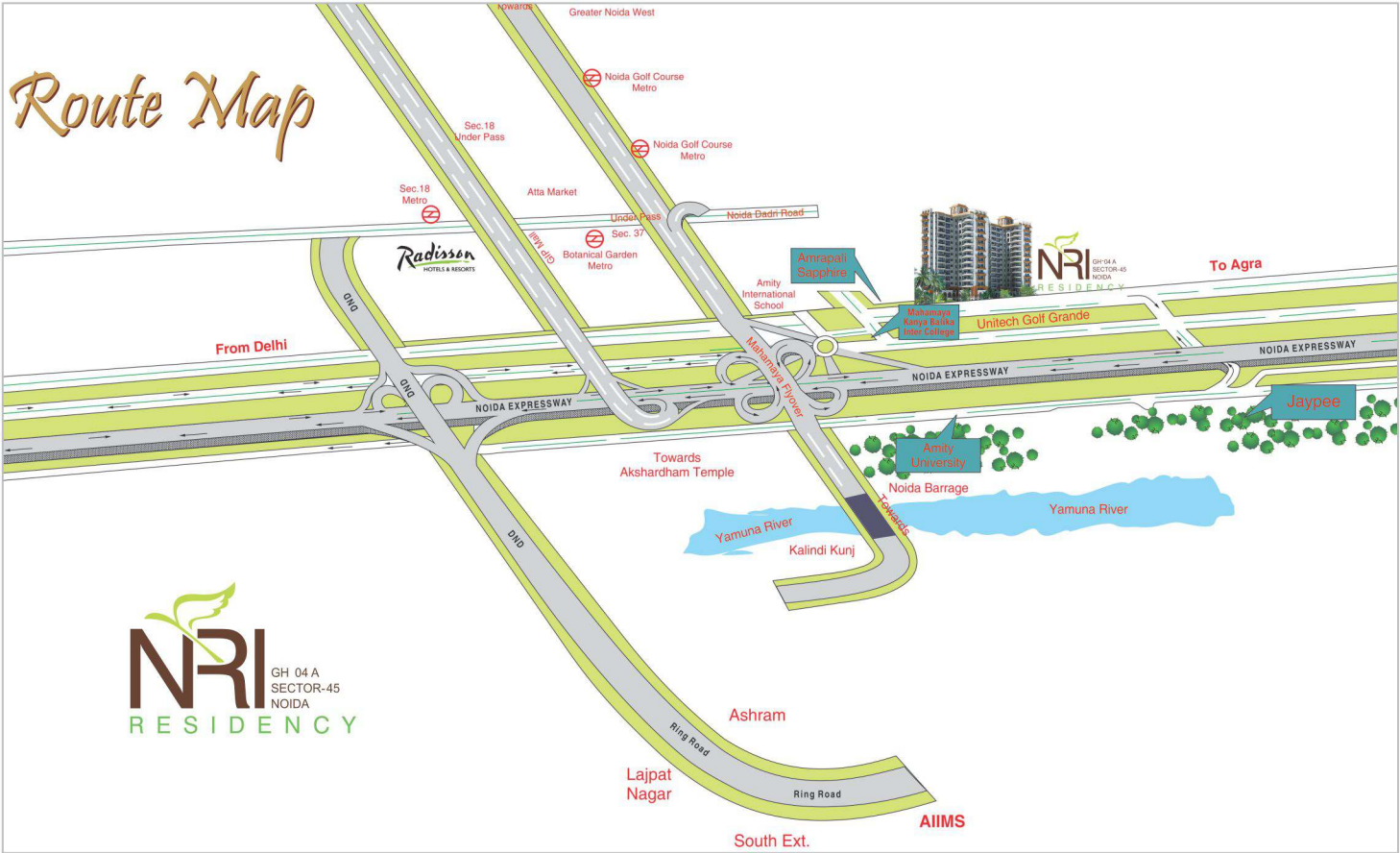

Distances (Approx. Within 3 to 5 Kms. Range)	
Hospitals	Max, Kailash, NMC, Prakash, Bhardwaj
Schools	DPS, Amity, Apeejay, Lotus, Step By Step, Pathways, Genesis
Commercial Hub	Sector -18, Sector -27, Sector -41, Sector -50

Home Loan by :

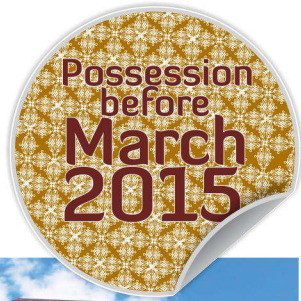

Actual Site View



Promoters & Developers :
SDS INFRATECH PVT LTD
Site : GH - 04 A, Sector - 45, NOIDA -201301 (INDIA)
Contact : +91-11-9818809564, 8800595952, 8800595953, 8800595954
E-mail : sales@sdsinfra.com **Website : www.sdsinfra.com**



EXPERIENCE THE LUXURY OF

Royal Living





T-8
3 Bedrooms
3 Toilets
Living Room
Dining Room
Servant Room with Toilet
Kitchen with Utility

After the grand success of Tower-1 to Tower-7
We bring you Luxurious Air Conditioned Apartments in T-8 & T-9
NRI RESIDENCY, NOIDA

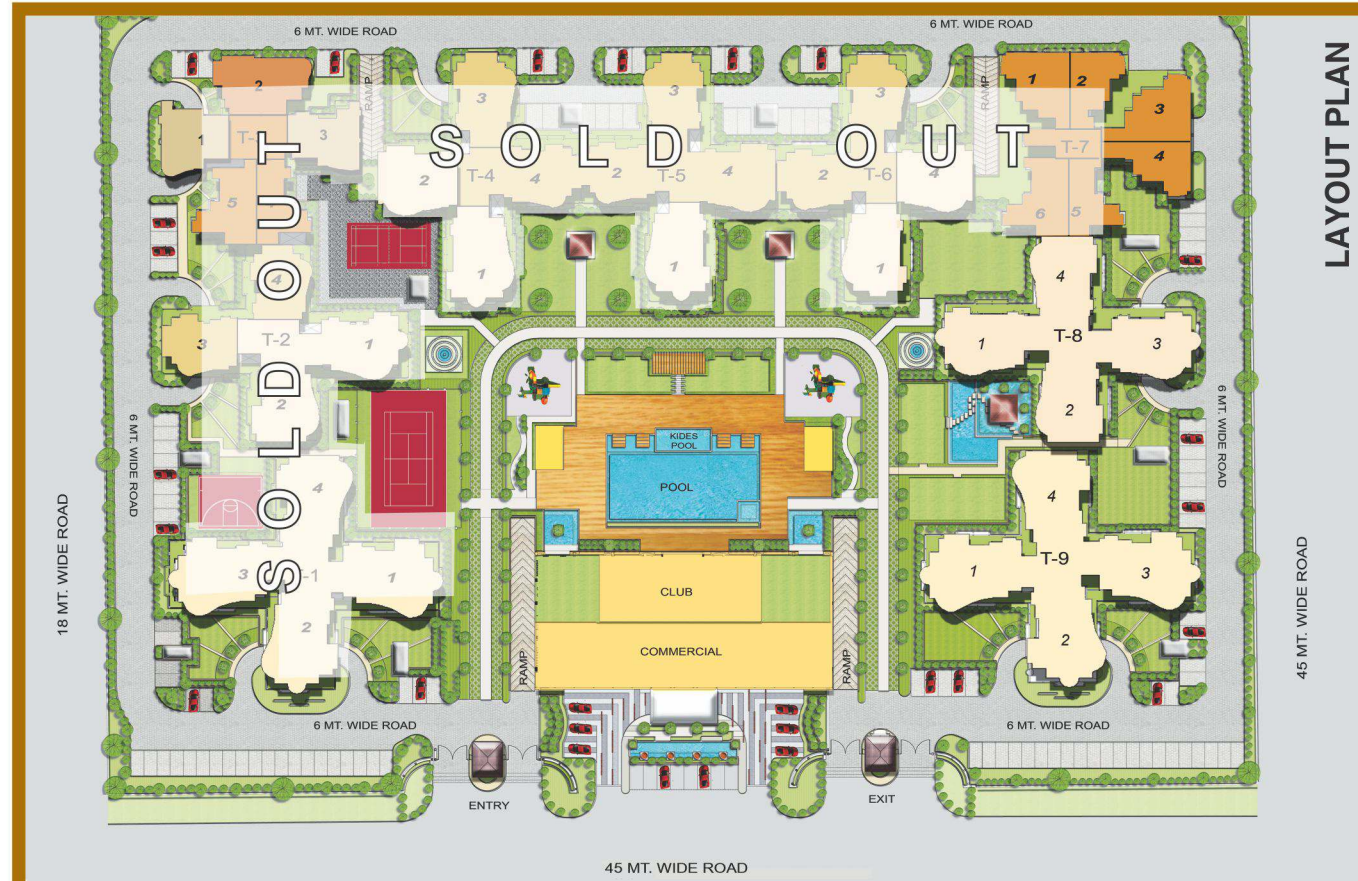

Amenities & Facilities

- 3 side open plot
- 70% open land / green area
- Featured entrance gate
- Entrance lobby in each tower with CCTV
- 2 high speed elevators for each tower
- Power back-up for complete essential services
- High ceiling apartments
- Theme landscaped garden and water bodies
- All apartments are cross ventilated
- State-of-art 2-tier security system
- Provisions for Gas Pipeline by Indraprastha Gas Limited (IGL)
- Provisions for DTH Services & Broadband via OFC
- Intercom and door video phone facility in each apartment
- 24 hr. Water supplies
- Top of the line CP fittings



T-9
4 Bedrooms
3 Toilets
Living Room
Dining Room
Pooja Ghar
Servant Room with Toilet
Kitchen with Utility

Lifestyle



Super Area - 1825 sqft. (Typical Floor Plan)



Luxury



Super Area - 2325 sqft. (Typical Floor Plan)